

NOTES:

- 1) COMPILED BY COMPUTER FROM ^{VOL 1107 380} PREVIOUS SURVEYS.
- 2) ALL POINTS ON CENTERLINE OF ROADS ARE NAIL & CAPS; ALL OTHER EXTERIOR POINTS OF TOTAL BOUNDARY ARE IRON PINS UNLESS OTHERWISE NOTED.

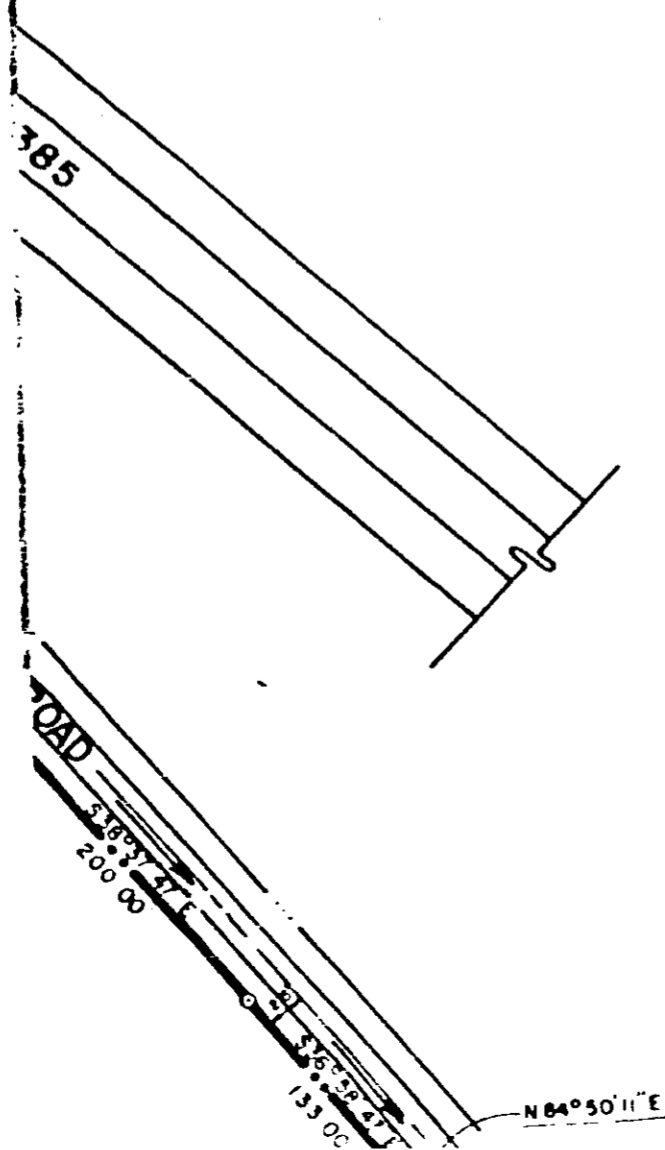

4328 RV.2

0.389